

ALL RED MATRIX				
TO	1	2	3	
1		15	18	
2	15		18	
3	18	18		

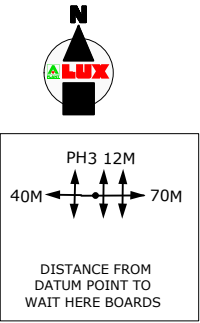

PHASE DIAGRAM	PHASE 1	PHASE 2	PHASE 3	
	GO →	← GO	GO GO GO	
	RED SETTINGS			
	15	15	12	
	GREEN SETTINGS (SECONDS)			
	45	45	7	

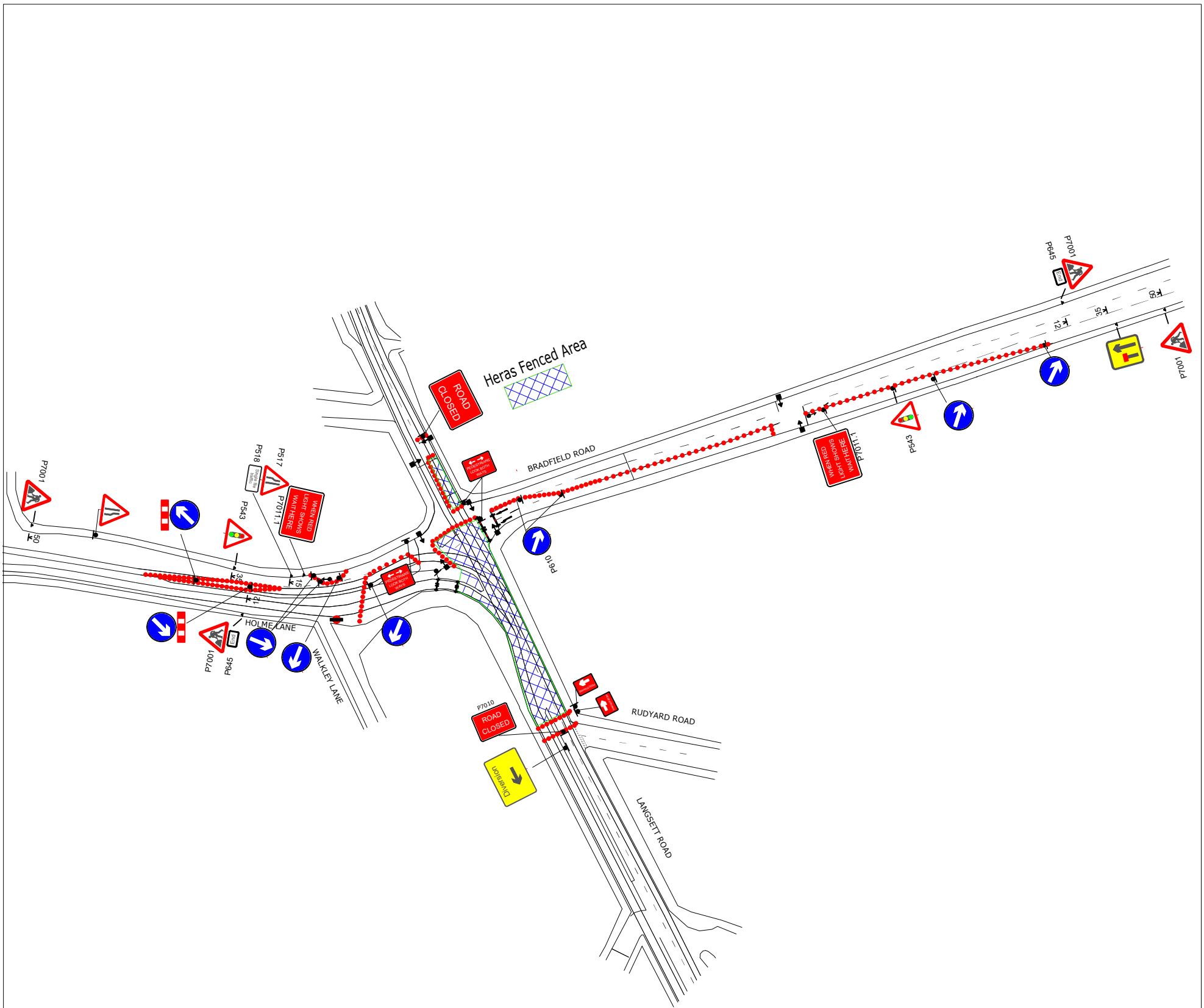

A-Plant Lux Traffic Control & Management  
Kemble Airfield Enterprise Park  
Cirencester Road  
Kemble  
GL7 6BQ  
Telephone : 01666 822000  
Fax: 0845 0047105

SPEED OF ROAD	30 MPH
DISTANCE FROM FIRST SIGN TO START OF SITE(D)	MIN 20 M MAX 45 M
SIDEWAYS SAFETY ZONE (S)	0.5 M
LONGWAYS CLEARANCE (L)	0.5 M

KEY:	
	3 light signal head
	Temporary Road Signs
	Permanent signal head
	Barrired Off Area
	Traffic controlled area
	Cone
	Pedestrian barrier
	Pedestrian crossing
	Bus stop

Running lanes  
3.5m maximum  
3.25m desirable minimum  
3.0m absolute minimum  
All signs will be 750mm  
and will be held in place  
with sandbags

DETAIL C2 Traffic cones  
(3m spacing)  
N.B Road Danger Lamps complying  
with Regulation 55  
should be provided during darkness

DRAWING DESCRIPTION  
Langsett Road,  
Hillsborough  
Sheffield,  
S6 2LP

CLIENT DETAILS  
VOLKER RAIL

DO WORK AT	PEAK TIMES	✓ X	WEEKEND	✓ X	OFF PEAK	✓ X	NIGHT	✓ X	DATE	18/03/2019
PURPOSE OF WORKS	DRAWN BY	REP / DEPOT	AMMEND No	SCALE		DIMENSIONS		SHEET NO		
CARRIAGEWAY WORKS	DC	SC/251	00	NOT TO SCALE		METRES		1 of 1		
PERMANENT LIGHTS AFFECT SITE?			✓ X		HIRE ADVICE site 15 &16 B					
PEDESTRIAN CROSSING AFFECTED?			✓ X							
BUS ROUTES / STOPS AFFECTED?			✓ X							

HIRE ADVICE site 15 &16 B